

Units For Standing Height Worktops

Use Unit Specification Guide to select range type
Use Worktop Specification Guide to select Worktop

Full Height Doors

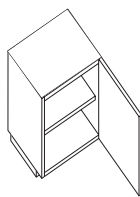
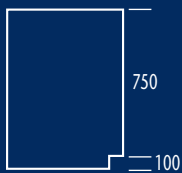

D75P (left) D76P (right)
Single door left/right
H750 x W500 x D450

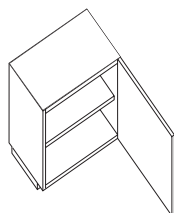

D110P (left) D111P (right)
Single door left/right
H750 x W600 x D450

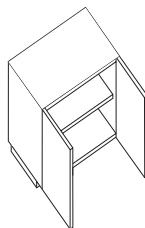

D79P
Double door
H750 x W600 x D450

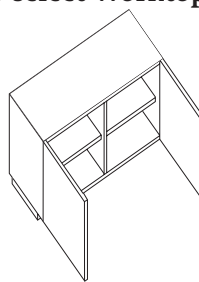

D80P
Double door
H750 x W1000 x D450

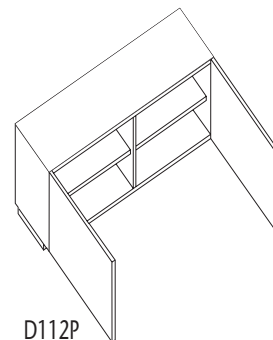

D112P
Double door
H750 x W1200 x D450

D77P (left) D78P (right)

D130P (left) D131P (right)

D81P

D82P

D132P

Also available
300 deep

Door With Drawer

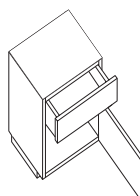
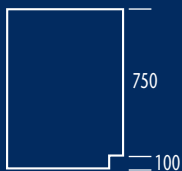

D60P (left) D61P (right)
Single door/drawer left/right
H750 x W500 x D450

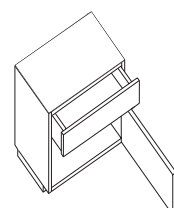

D62P (left) D63P (right)
Single door/drawer left/right
H750 x W600 x D450

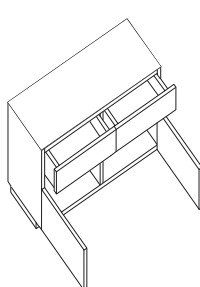

D64P
Double drawer and door
H750 x W1000 x D450

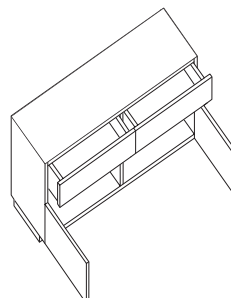

D65P
Double drawer and door
H750 x W1200 x D450

Sink Units

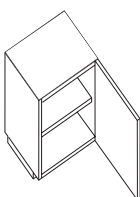
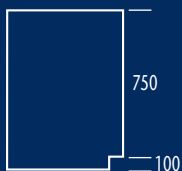

D75SP (left) D76SP (right)
Single door left/right
H750 x W500 x D450

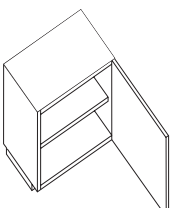

D110SP (left) D111SP (right)
Single door left/right
H750 x W600 x D450

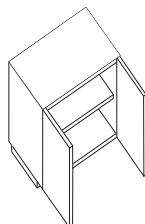

D79SP
Double door
H750 x W600 x D450

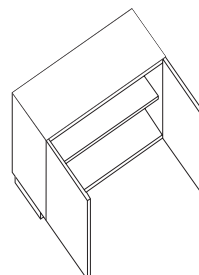

D80SP
Double door
H750 x W1000 x D450

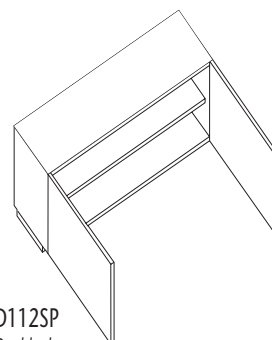

D112SP
Double door
H750 x W1200 x D450

Corner Units

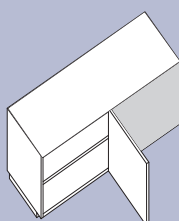
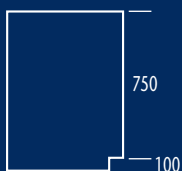

D122P
Corner single door (left)
H750 x W900 x D450

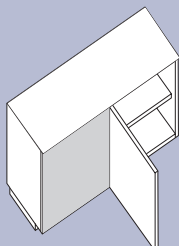

D123P
Corner single door (right)
H750 x W900 x D450

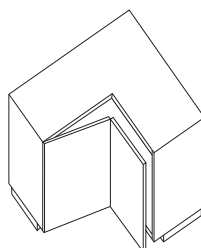

D120P
Corner bifold door (left)
H750 x W900 x W900 x D450

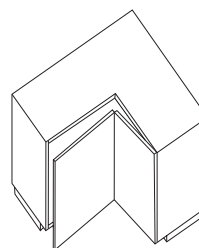

D121P
Corner bifold door (right)
H750 x W900 x W900 x D450



DFP
Front infill
Multiples of 50W

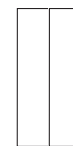

DCP
Corner infill

Doors available 500/600 wide

Open Storage

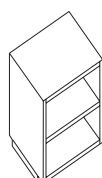
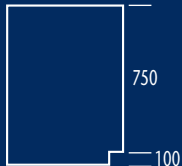

D73P
Open base unit
H750 x W500 x D450

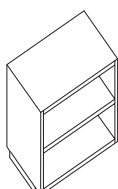

D74P
Open base unit
H750 x W600 x D450

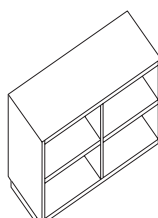

D173P
Open base unit
H750 x W1000 x D450

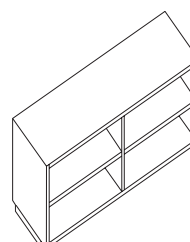

D174P
Open base unit
H750 x W1200 x D450

Units For Standing Height Worktops

Use Unit Specification Guide to select range type
Use Worktop Specification Guide to select Worktop

Drawer Units

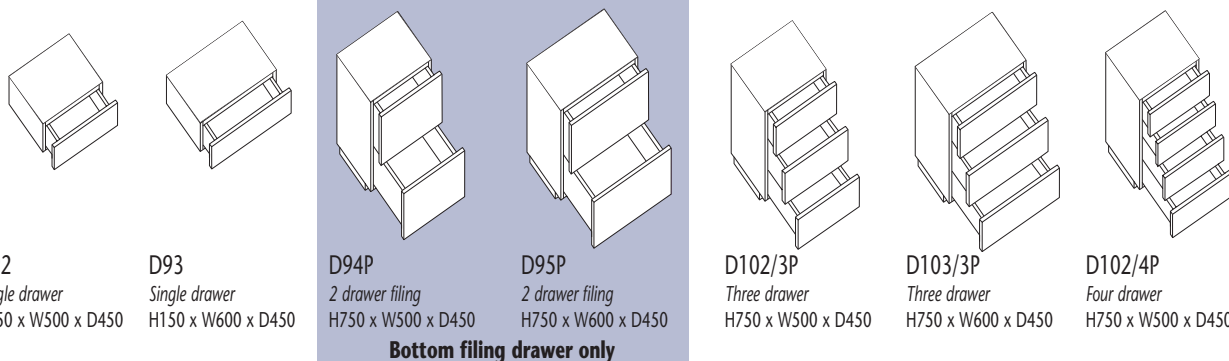
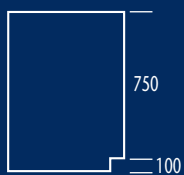

D92
Single drawer
H150 x W500 x D450

D93
Single drawer
H150 x W600 x D450

D94P
2 drawer filing
H750 x W500 x D450

D95P
2 drawer filing
H750 x W600 x D450

D102/3P
Three drawer
H750 x W500 x D450

D103/3P
Three drawer
H750 x W600 x D450

D102/4P
Four drawer
H750 x W500 x D450

Bottom filing drawer only

Multiple drawer units have central locking systems when required

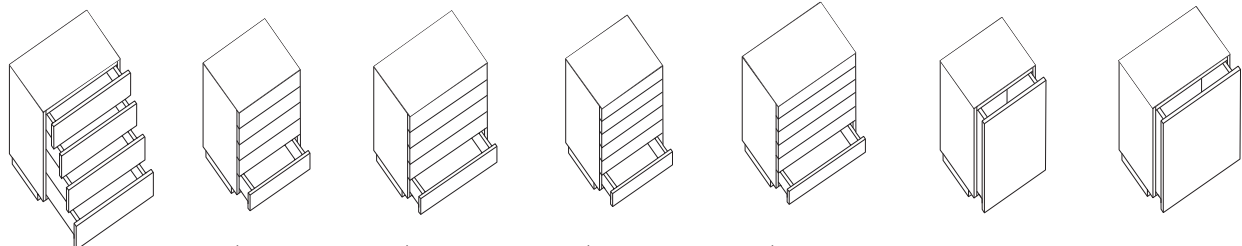

D103/4P
Four drawer
H750 x W600 x D450

D102/5P
Five drawer
H750 x W500 x D450

D103/5P
Five drawer
H750 x W600 x D450

D102/6P
Six drawer
H750 x W500 x D450

D103/6P
Six drawer
H750 x W600 x D450

D88P
Single pull out front
H750 x W500 x D450

D89P
Single pull out front
H750 x W600 x D450

Mobiles

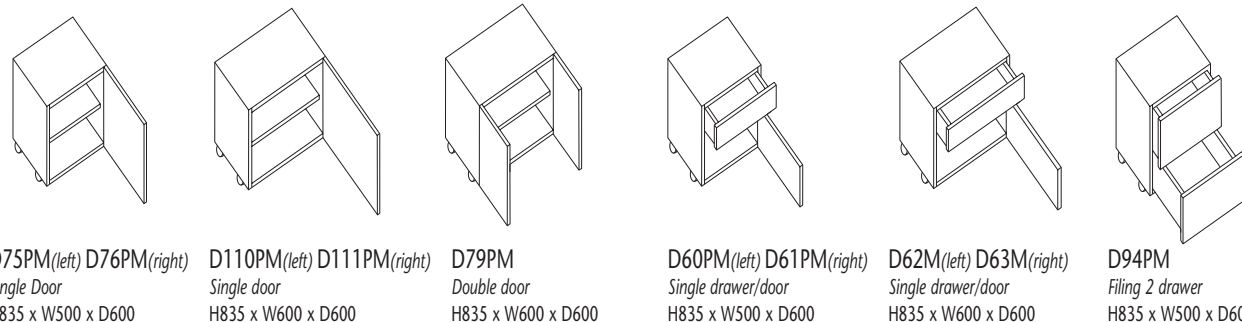
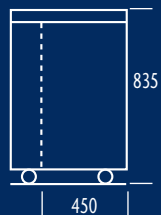

D75PM(left) D76PM(right)
Single Door
H835 x W500 x D600

D110PM(left) D111PM(right)
Single door
H835 x W600 x D600

D79PM
Double door
H835 x W600 x D600

D60PM(left) D61PM(right)
Single drawer/door
H835 x W500 x D600

D62M(left) D63M(right)
Single drawer/door
H835 x W600 x D600

D94PM
Filing 2 drawer
H835 x W500 x D600

Multiple drawer units have central locking systems when required

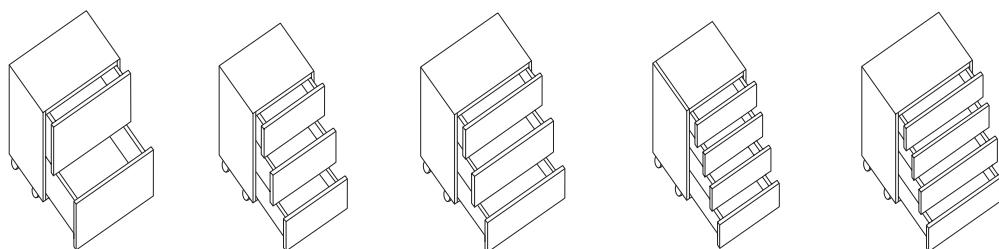

D95PM
Filing 2 drawer
H835 x W600 x D600

D102/3PM
Three drawer
H835 x W500 x D600

D103/3PM
Three drawer
H835 x W600 x D600

D102/4PM
Four drawer
H835 x W500 x D600

D103/4PM
Four drawer
H835 x W600 x D600

For leg supports see page 11

Tall Storage

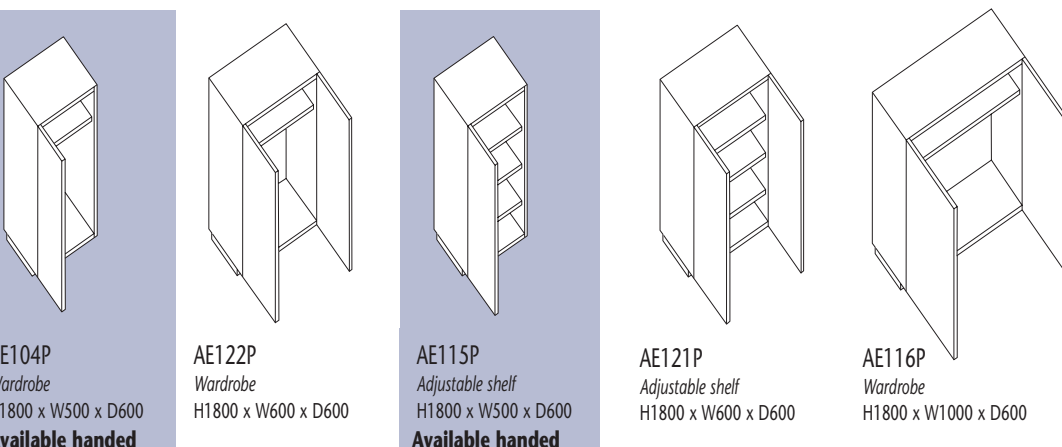

AE104P
Wardrobe
H1800 x W500 x D600

AE122P
Wardrobe
H1800 x W600 x D600

AE115P
Adjustable shelf
H1800 x W500 x D600

AE121P
Adjustable shelf
H1800 x W600 x D600

AE116P
Wardrobe
H1800 x W1000 x D600

AE102P

AE112P

AE103P

AE113P

Also available 300 deep

