

# Wall Units

Use Unit Specification Guide to select range type

## Open Storage

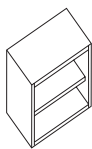

**A150**  
Open wall unit  
H550 x W500 x D300

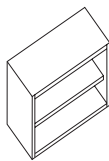

**A160**  
Open wall unit  
H550 x W600 x D300

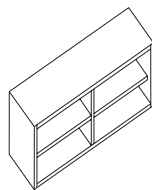

**A170**  
Open wall unit  
H550 x W1000 x D300

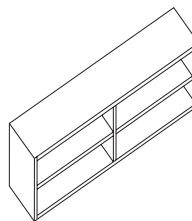

**A320**  
Open wall unit  
H550 x W1200 x D300

## Units With Doors

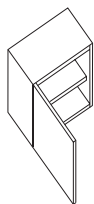

**A14(left)**  
Single door cupboard  
H550 x W500 x D300

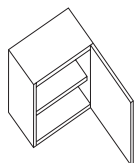

**A15(right)**  
Single door cupboard  
H550 x W500 x D300

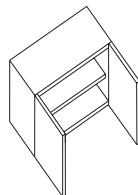

**A16**  
Double door cupboard  
H550 x W600 x D300

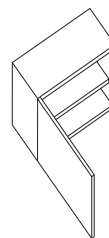

**A30**  
Single door cupboard  
H550 x W600 x D300

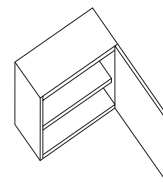

**A31**  
Single door cupboard  
H550 x W600 x D300

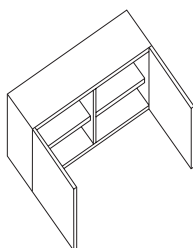

**A17**  
Double door cupboard  
H550 x W1000 x D300

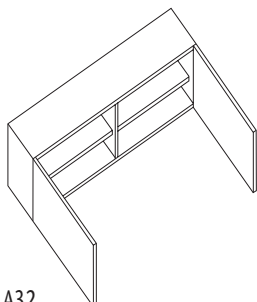

**A32**  
Double door cupboard  
H550 x W1200 x D300

Sloping Tops  
Available As An Extra

## Corner Units

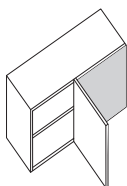

**A35**  
Corner single door (left)  
H550 x W650 x D300

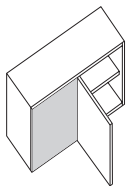

**A36**  
Corner single door (right)  
H550 x W650 x D300

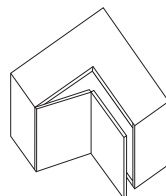

**A33**  
Corner bifold door (left)  
H550 x W650 x W650 x D300

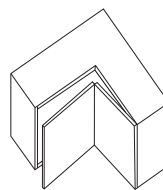

**A34**  
Corner bifold door (right)  
H550 x W650 x W650 x D300



**AFP**  
Infill soffit & top  
Multiples of 50

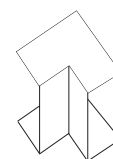

**ACP**  
Corner infill panel

## Medicine/ Drugs

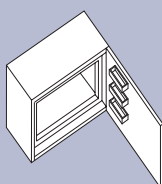

**A18R(right)**  
Medicine cupboard, lockable  
swing out interior, door racks  
H550 x W600 x D300

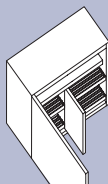

**A19L(left)**  
Ward drugs cupboard  
H550 x W600 x D300

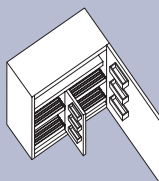

**A19R(right)**  
Ward drugs cupboard  
H550 x W600 x D300

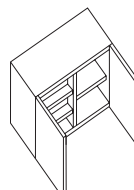

**A20**  
Urine test cupboard, lockable  
H550 x W600 x D300

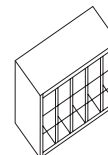

**A21**  
Pack dispenser  
H550 x W600 x D300

Security locks included

