

Units For Sitting Height Worktops

Use Unit Specification Guide to select range type
Use Worktop Specification Guide to select Worktop

Drawer Units

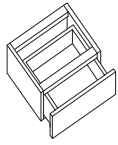

D92
Single drawer
H150 x W500 x D450

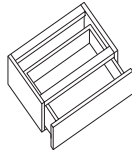

D93
Single drawer
H150 x W600 x D450

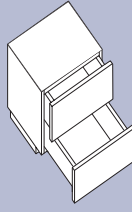

D94CP
Filing drawer
H550 x W500 x D450

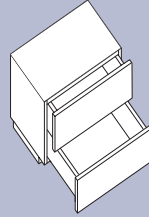

D95CP
Filing drawer
H550 x W600 x D450

Bottom filing drawer only

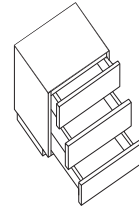

D102/3CP
Three drawer
H550 x W500 x D450

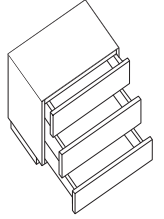

D103/3CP
Three drawer
H550 x W600 x D450

Multiple drawer units have central locking systems when required

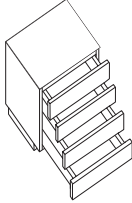

D102/4CP
Four drawer
H550 x W500 x D450

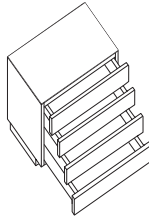

D103/4CP
Four drawer
H550 x W600 x D450

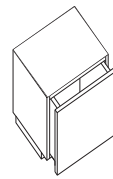

D88CP
Single pull out front
H550 x W500 x D450

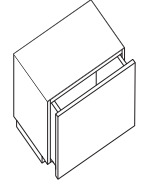

D89CP
Single pull out front
H550 x W600 x D450

Mobiles

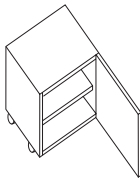
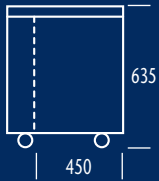

D75CM(left) D76CM(right)
Single Door
H635 x W500 x D600

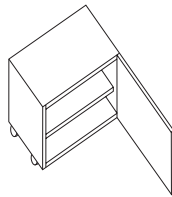

D110CM(left) D111CM(right)
Single door
H635 x W600 x D600

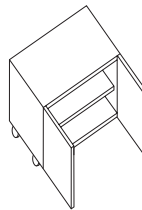

D79CM
Double door
H635 x W600 x D600

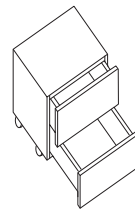

D94CM
Filing 2 drawer
H635 x W500 x D600

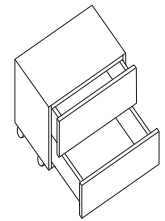

D95CM
Filing 2 drawer
H635 x W600 x D600

Multiple drawer units have central locking systems when required

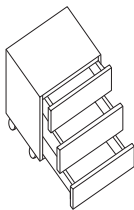

D102/3CM
Three drawer
H635 x W500 x D600

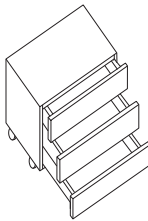

D103/3CM
Three drawer
H635 x W600 x D600

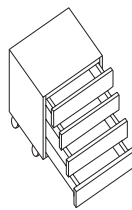

D102/4CM
Four drawer
H635 x W500 x D600

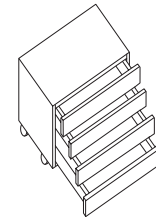

D103/4CM
Four drawer
H635 x W600 x D600

For leg supports see page 11

Tall Storage

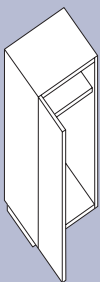

AE104P
Wardrobe
H1800 x W500 x D600
Available handed

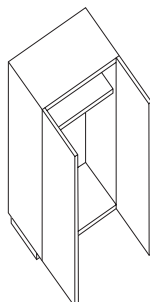

AE122P
Wardrobe
H1800 x W600 x D600

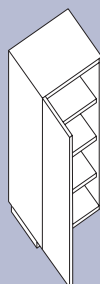

AE115P
Adjustable shelf
H1800 x W500 x D600
Available handed

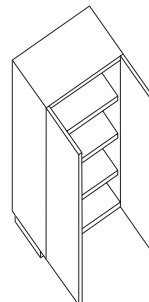

AE121P
Adjustable shelf
H1800 x W600 x D600

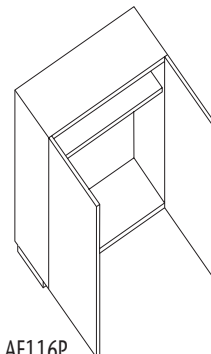

AE116P
Wardrobe
H1800 x W1000 x D600

Also available 300 deep

AE102P

AE112P

AE103P

AE113P

